

1-Line Bidirectional ESD Protection Diode

Description

The SESDB5V0D5 is designed to protect voltage sensitive components from ESD and transient voltage events. Excellent clamping capability, low leakage, and fast response time, make these parts ideal for ESD protection on designs where board space is at a premium.

Features

- Reverse stand-off voltage: 5.0V Max
- Low leakage current: nA Level
- Low Clamping Voltage
- Response time is typically < 1 ns
- IEC61000-4-2 Level 4 ESD Protection

Schematic and Pin Configuration

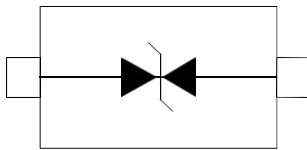

Graphic symbol

Mechanical Characteristics

- Package: SOD-523
- Case Material: "Green" Molding Compound.
- Moisture Sensitivity: Level 1 per J-STD-020
- Marking Information: See Below

Applications

- Cell phones
- Audio equipment
- Portable devices
- Digital cameras
- Power supplies

Ordering Information

Part Number	Packaging	Package
SESDB5V0D5	3000/Tape & Reel	SOD-523

Absolute Maximum Ratings ($T_A=25^{\circ}\text{C}$ unless otherwise specified)

Parameter	Symbol	Value	Unit
Peak Pulse Power (8/20 μs)	P_{PK}	80	W
Peak Pulse Current (8/20 μs)	I_{PP}	5	A
ESD per IEC 61000-4-2 (Air)	V_{ESD}	± 30	kV
ESD per IEC 61000-4-2 (Contact)		± 30	
Operating Temperature Range	T_{OP}	-55 to +125	$^{\circ}\text{C}$
Storage Temperature Range	T_{STG}	-55 to +150	$^{\circ}\text{C}$

Electrical Characteristics ($T_A=25^{\circ}\text{C}$ unless otherwise specified)

Parameter	Symbol	Min	Typ	Max	Unit	Test Condition
Reverse Working Voltage	V_{RWM}			5.0	V	
Breakdown Voltage	V_{BR}	5.6			V	$I_T = 1\text{mA}$
Reverse Leakage Current	I_R			100	nA	$V_{RWM} = 5.0\text{V}$
Clamping Voltage	V_C			16.0	V	$I_{PP} = 5\text{A}$ (8/20 μs pulse)
Junction Capacitance	C_J		18		pF	$V_R = 0\text{V}$, $f = 1\text{MHz}$

Typical Performance Characteristics (T_A=25°C unless otherwise Specified)

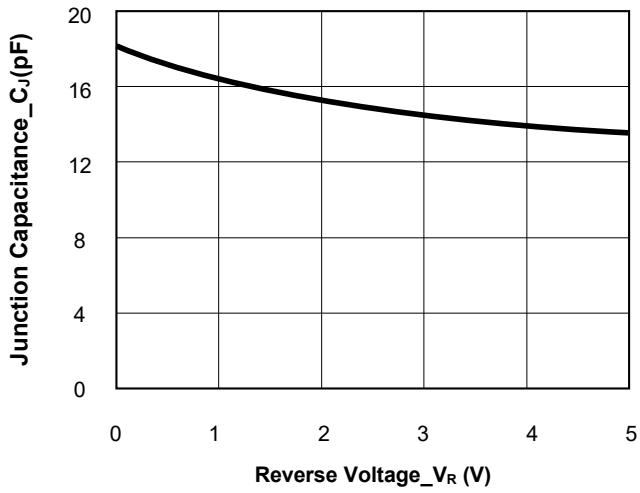

Junction Capacitance vs. Reverse Voltage

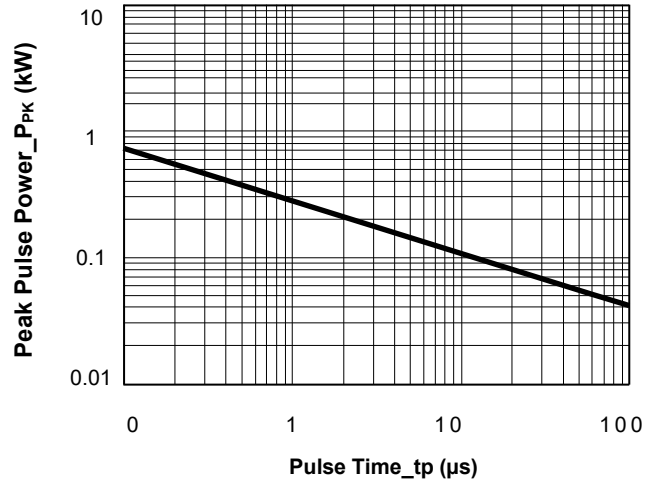

Peak Pulse Power vs. Pulse Time

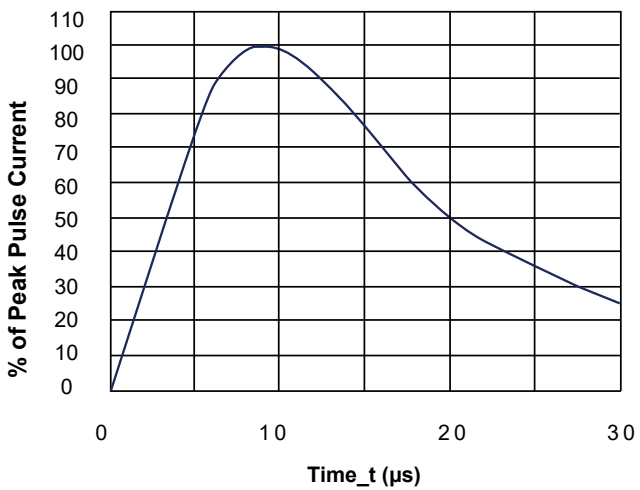

8/20μs Pulse Waveform

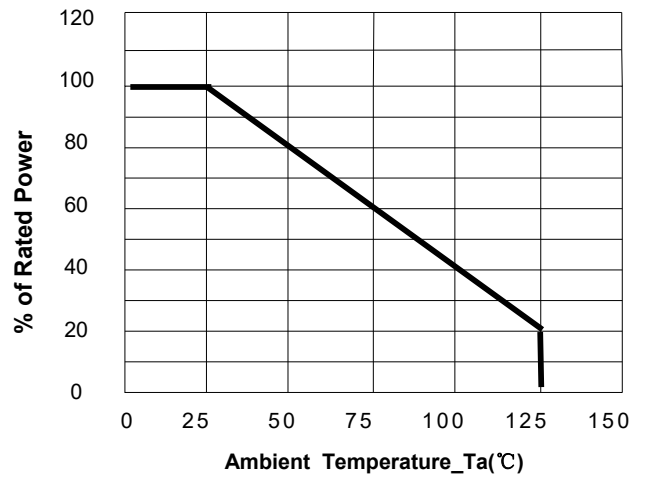

Power Derating Curve

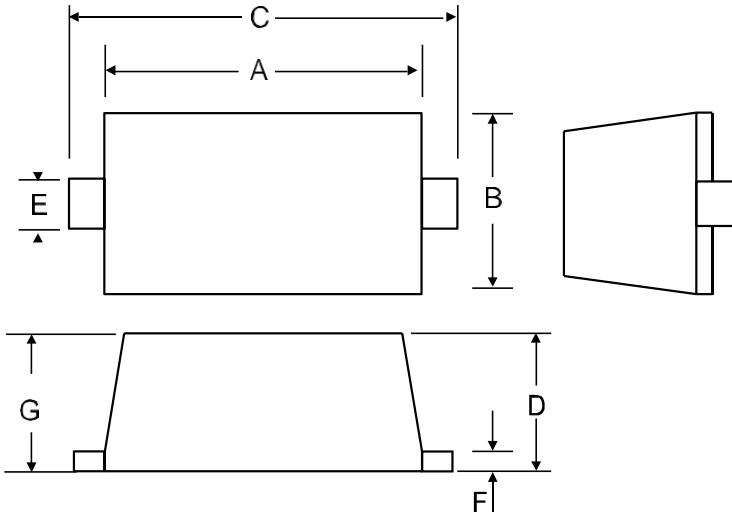
SOD-523 Package Outline Drawing

SYM	DIMENSIONS			
	MILLIMETERS		INCHES	
	MIN	MAX	MIN	MAX
A	1.10	1.30	0.043	0.051
B	0.70	0.90	0.028	0.035
C	1.50	1.70	0.059	0.067
D	0.50	0.70	0.020	0.028
E	0.25	0.35	0.010	0.014
F	0.10	0.20	0.004	0.008
G	0.50	0.70	0.020	0.028

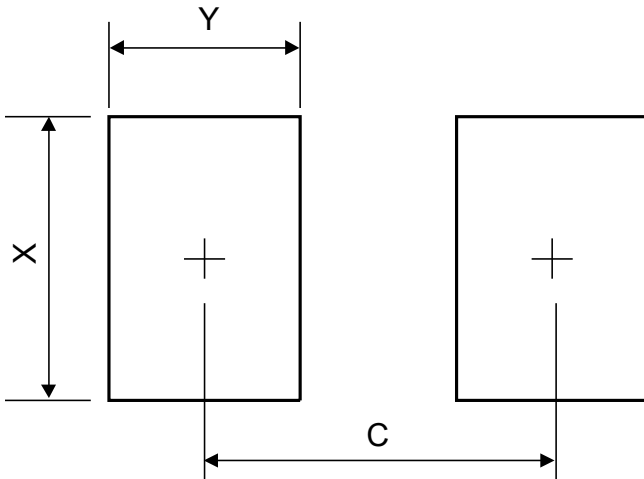
Suggested Land Pattern

SYM	DIMENSIONS	
	MILLIMETERS	INCHES
C	1.42	0.056
X	0.70	0.028
Y	0.60	0.024

TAPE AND REEL INFORMATION

Reel Dimensions

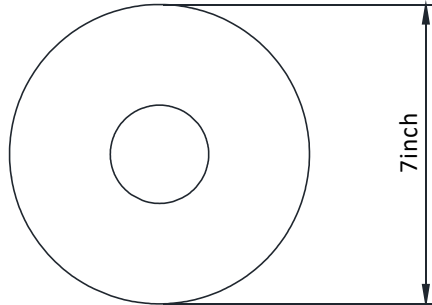

Tape Dimensions

